

B120/12900

Bedienungsanleitung +
Bestandsliste

SELF-GOVERNING COOLANT SYSTEM TANK



INSTRUCTIONS & INSTALLMENT



SPECIFICATIONS:

MOTOR 1/8HP, 1PH/3PH

LIFT / METER 2.5M

DIMENSION 390MM x 260MM x 320MM

TANK VOLUME 9 Litter

WEIGHT Gross 8.2 kgs, Net 7.5kgs

ELECTRICAL CONNECTIONS:

The electrical connections should be carried out in accordance with local regulations.

The operating voltage and frequency are marked on the name plate. Make sure that the motor is suitable for the electricity supply on which it will be used. And the pump must be connected to an external on/off switch.

Note : Never make any connections in the pump terminal box unless the electricity supply has been switched off. Single phase motor don't incorporate motor protection and must be connected to an approved motor starter. Three phase motor is connected to a motor starter, the set nominal current of which must correspond to the electrical data on the pump name plate.

Connections should be made as shown on the inside of the terminal box cover.

CHECKING OF DIRECTION OF ROTATION : (Three phase pump)

Arrows on the motor top cover indicate the correct direction of rotation. The pump should rotate counter - clockwise when viewed from the motor end. To reverse the direction of rotation, switch off the electricity supply and interchange any two of the incoming supply wires.

STARTING:

Priming: Do not start the pump until half part of the prop stand of pump has been filled with liquid and vented.

Note : In systems with hot liquids, extreme caution should be exercised when venting the pump to eliminate the risk of personal injury caused by escaping water.

Make sure the pump should be installed above the tank, then the fixed screws are tightened securely between the prop stand and cover on the tank. Make sure the electrical connections should be carried out in accordance with local regulations. Make sure the joints of the pipes must be completely tight.

FREQUENCY OF STARTS AND STOPS : Maximum 100 starts per hour.

OPERATION AND MAINTENANCE:

Under normal operating conditions, the pump does not require any maintenance. If this pump has been used for pumping liquids which may leave impurities in the pump, it should be flushed through with clean water immediately after use.

FROST PROTECTION:

Pumps which are not being used during periods of frost must be drained to avoid damage.

1. Take out the pump from the tank.
2. Draw out the three screws which from the bottom cover of pump.
3. Open the bottom cover and keep inside is frost free position.
4. Don't replace the bottom cover until the pump is to be used again.

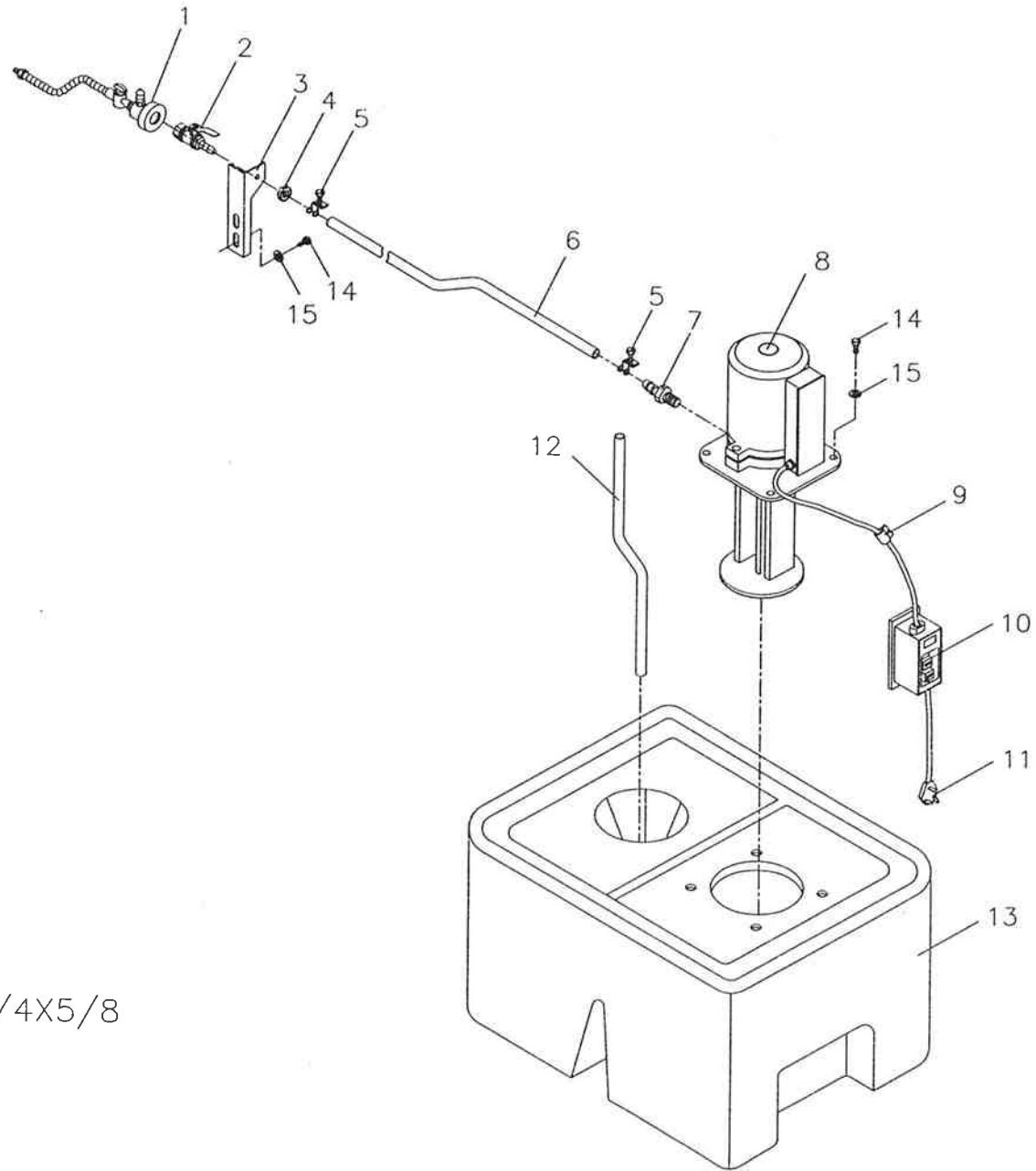

- 1 Nozzle
- 2 Valve
- 3 Supporter
- 4 Nut 1/2
- 5 Clamp (13mm)
- 6 Hose 5/16(2m)
- 7 Connector
- 8 Pump
- 9 Wire Grip
- 10 Switch
- 11 Power Cord
- 12 Hose 3/8(1M)
- 13 Tank
- 14 Hex. Hd. Screw 1/4X5/8
- 15 Washer 1/4