

technical sheet

DYNAFOR LLX LCD load indicators capacities : 250 kg to 250 t

réf. : T 2001 GB
rév. n° : 7
date : 03/03
page : 1/2

General specification :

Lifting accessory in accordance with CE directives
N°89/392 - 91/368 - 93/68 and European Standards N° EN 292 - EN 55 022
- EN 50 082.2

Liquid cristal display (LCD) : 5 digits
models LLX-0.25 to LLX-5 : 18 mm digits
models LLX-12.5 to LLX-100 : 25 mm digits
model LLX-250 : 44 mm digits

Ambient temperature range : -10°C to +40°C
Temperature compensation : automatic zero adjustment when equipment
free of any load is switched ON

Weatherproof and dustproof : IP65

Material : body in aluminium alloy

Finish : anodised black

Power supply : 3 x 1.5 V, AA or R6 (dia. 14 x 50 mm) standard

Power consumption : variable, depending on the
setting of the functions

Battery life : 550 hours

Accuracy : +/- 0.2% of capacity

Operating coefficient : max. 2

Safety coefficient : 4



Push-button controls :

- ON / OFF (T1)
- TARE (up to 100% of capacity) (T2)
- PEAK HOLD (T3)



T1



T2



T3

Automatic functions :

- Automatic zero when switched on
- Low battery signal
- Overload indication

Adjustable functions (using a sequence of operations of the push-buttons) :

- Choice of unit measurement : Unit display (kg, t, short ton, lbs, daN, kN)
- Automatic shutdown after 20 minutes with no addition/reduction of load
- Response rate of the display

Output (BNC socket) :

- to connect to remote readout
- to connect to PC, for data processing and printing
- to connect to "Dynafor" printer

Options :

- Remote hand held display suitable for use with all models (ON/OFF; tare, Peak hold).
- RS232 for connection to PC, Printer, etc.
- Portable DYNAFOR printer : customised print-out with date and time.
- Supply network

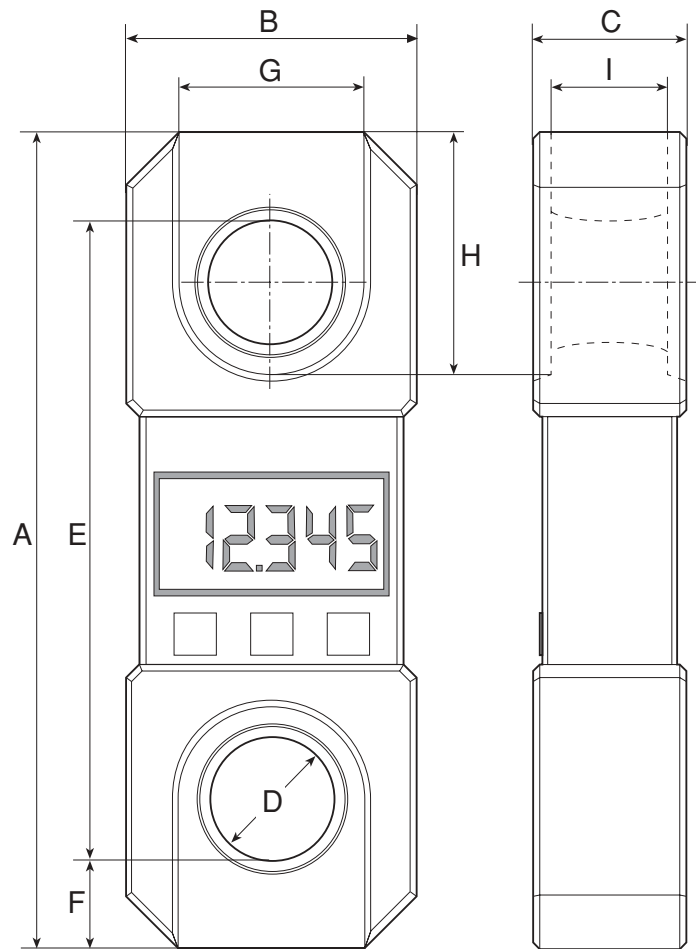

Technical specification :

Model		LLX-0.25	LLX-0.5	LLX-1.25	LLX-2.5	LLX-5	LLX-12.5	LLX-25	LLX-50	LLX-100	LLX-250
Capacity	t	0.25	0.50	1.25	2.5	5	12.5	25	50	100	250
Accuracy	±kg	0.5	1	2.5	5	10	25	50	100	200	500
Smallest load increm.	kg	0.1	0.2	0.5	1	2	5	10	20	50	100
Test load	t	0.5	1	2,5	5	10	25	50	85	145	333
Max. display	kg/t	250.0	500.0	1250.0	2500	5000	12500	25000	50000	100.00	250,00
Height of digits	mm	18	18	18	18	18	25	25	25	25	44
Weight	kg	1.1	1.1	1.1	1.4	1.9	3.8	6.6	15.1	46	215
Material		Aluminium alloy									
Dimensions mm	A	190	190	190	214	226	310	360	440	660	905
	B	83	83	83	83	90	110	134	164	260	424
	C	56	56	56	56	56	58	68	98	118	248
	D	16	16	16	24	32	47	56	72	108	150
	E	166	166	166	184	197	243	272	332	488	685
	F	12	12	12	15	14,5	33,5	44	54	86	110
	G	47	47	47	47	54	70	84	104	174	250
	H	43	43	43	50	58	92	114	142	227	310
	I	16	16	16	25	32	48	58	86	104	190